

Product Information

Level Switch
NM-004HK



- Cover or base mounting for monitoring max. or min. level
- normally closed or normally open contact

Characteristics

Mechanical level monitor for fluid media, with contact-free triggering of a reed contact.

Technical data

Switch	reed switch
Process connection	male thread G 1/8 A
Density of medium	≥ 0.75 g/cm ³
Pressure resistance	PN 10 bar
Medium temperature	-20..+105 °C
Ambient temperature	-20..+55 °C
Media	water, oils
Wiring	'normally open' or 'normally closed' No. 0.442
	<p>the switching function can be modified by changing the float.</p>
Switching voltage	max. 250 V AC
Switching current	max. 0.5 A

Switching capacity	max. 70 VA
Protection class	2 - safety insulation
Ingress protection	IP 65
Electrical connection	cabl 1.5 m
Materials medium-contact	1.4571
Non-medium-contact materials	PVC
Weight	0.06 kg
Installation location	vertical installation position

Dimensions

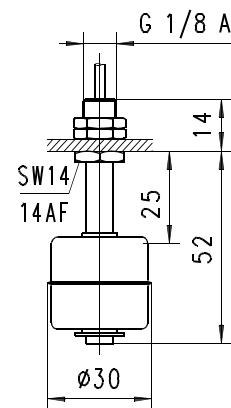

Details of float location 25 mm for density 1 g/cm³.
 The device is delivered without a seal.

Handling and operation

- It must be ensured that the values given for voltage, current, and power are not exceeded.
- When switched on, a load must be connected in series.
- The electrical details apply to ohmic loads. Capacitive, inductive and lamp loads must be operated using a protective circuit.
- Not suitable for use in media with ferritic particles.

Ordering code

NM - 1. 004 2. H 3. K

1. Connection size	004	threaded connection G 1/8 A
2. Process connection	H	screw-in thread
3. Connection material	K	stainless steel